

# Telecommunications Speakers (continued)

## Unique Round Frame Design\*

Part Number	Frame Diameter (mm)	Frame Depth (mm)	Rated Power (watts)		Voice Coil Impedance (Ohms)	Resonant Response (Hz)	Frequency Response (dB)	SPL (dB)	Magnet	Net Weight (Ounces)
			Nom.	Max.						
S200RA-MB	50	18.7	0.2	0.4	8 ± 15%	500 ± 20%	Fo ~ 4500	84	Alnico	1.51

### S200RA-MB

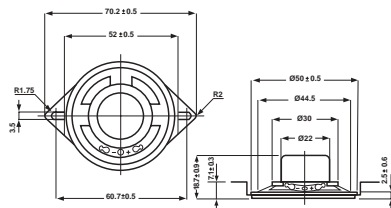

# Shielded Low Leakage Speakers\* For Computer and TV Applications, etc.

## Plastic Oval Frame Types

Part Number	Frame Diameter (mm)	Frame Depth (mm)	Rated Power (watts)		Resonant Frequency (Hz)	Frequency Response (Hz)	SPL (dB)	Cone Material	Net Weight (Ounces)	Mounting Dimensions Dia. (mm)
			Nom.	Max.						
SR55X10VN	14 x 25	5.2	1.0	1.5	600 ± 20%	Fo ~ 4000	81	Paper	0.08	11 x 22
SR60X14VNS	16 x 35	4.2	1.0	1.5	650 ± 20%	Fo ~ 4000	82	Paper	0.07	13 x 31
SR60X14VN	16 x 35	8	1.0	2.0	550 ± 20%	Fo ~ 13000	84	Paper	0.15	12 x 31
SR80X14VNS	20 x 35	5.3	1.0	1.5	590 ± 20%	Fo ~ 20000	86	Plastic	0.15	16 x 31
SR80X16VN	20 x 40	5.3	0.5	1.0	550 ± 20%	Fo ~ 20000	83	Plastic	0.15	16 x 36
S11X16VN-2W	28.5 x 40	13.0	2.0	4.0	350 ± 20%	Fo ~ 20000	89	Paper	0.58	22 x 33.5
S11X16VNS-2W	28.5 x 40	11.3	2.0	3.0	350 ± 20%	Fo ~ 20000	83	Paper	0.42	22 x 33.5
S11X16VNS	28.5 x 40	11.3	1.0	2.0	390 ± 20%	Fo ~ 20000	82	Paper	0.42	22 x 33.5

## Metal Oval Frame Types

Part Number	Frame Diameter (mm)	Frame Depth (mm)	Rated Power (watts)		Resonant Frequency (Hz)	Frequency Response (Hz)	SPL (dB)	Cone Material	Net Weight (Ounces)	Mounting Dimensions Dia. (mm)
			Nom.	Max.						
S15X25VA	40 x 70	29.8	3.0	5.0	280 ± 20%	Fo ~ 15000	82	Paper	1.90	33.4 x 63.4
S20X35VFS-2W	50 x 90	36.5	3.0	5.0	200 ± 20%	Fo ~ 20000	83	Paper	3.93	40 x 75
S20X35VFS-5W	50 x 90	41.6	5.0	8.0	200 ± 20%	Fo ~ 20000	90	Paper	3.93	40 x 75

### Plastic Oval Frame Types

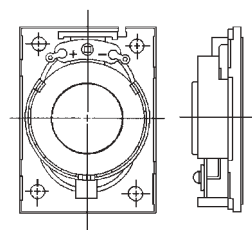

### S15X25VA

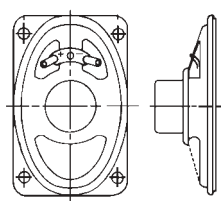

### S20X35VFS Series

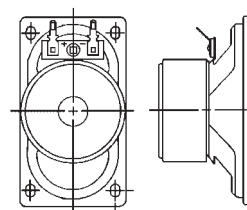

\*Standard voice coil impedance 8 ohms ± 15%. These speakers can be supplied with a variety of voice coil impedances. The most common impedances are 4, 16, 32, 45 and 100 ohms.